

WORKSHOP PRACTICE-II

(Code : MEP-402)

(Practical)

Full Marks : 50

Time : 4 hours

Prepare any **one** job as per drawing given below

1. Prepare the turning job using Lathe.

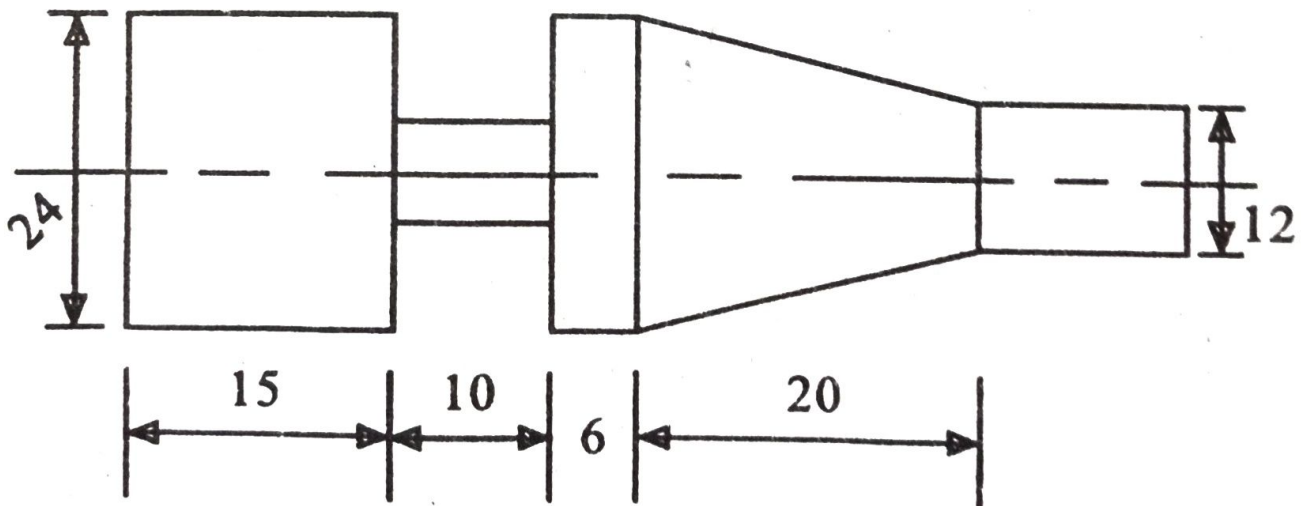

(Turn Over)

(2)

2. Prepare the welding job by Arc Welding.

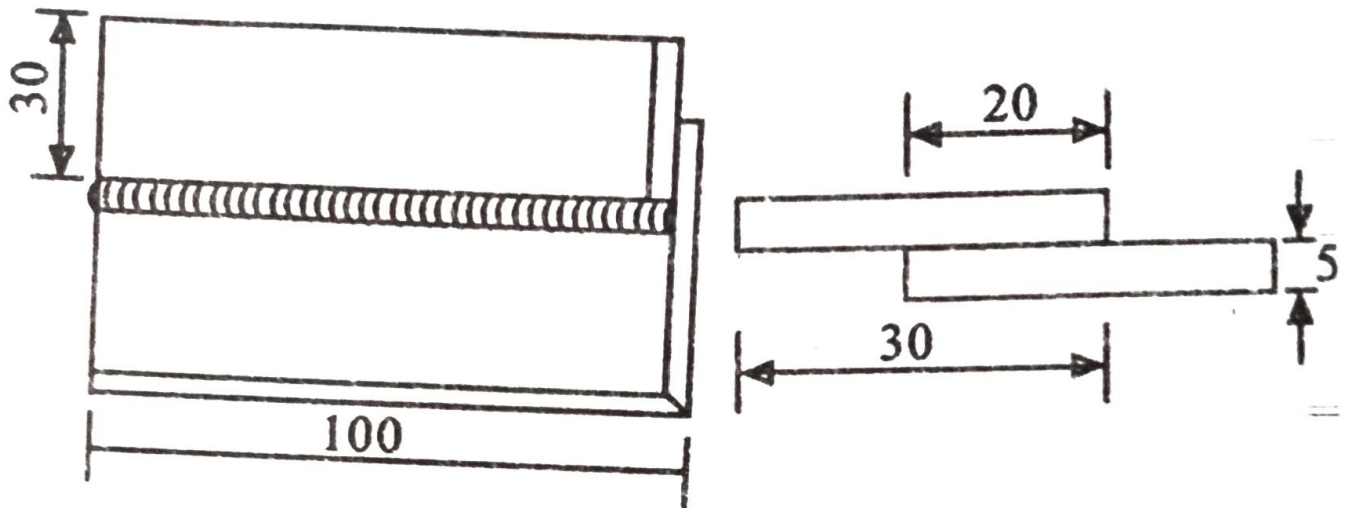

ALL DIMENSIONS ARE IN MM.

WORKSHOP PRACTICE - III

(Code : MEP-402)

Full Marks : 50

Time : 4 hours

Answer any one question

1. Prepare a 'square butt joint' as shown below through are welding process.

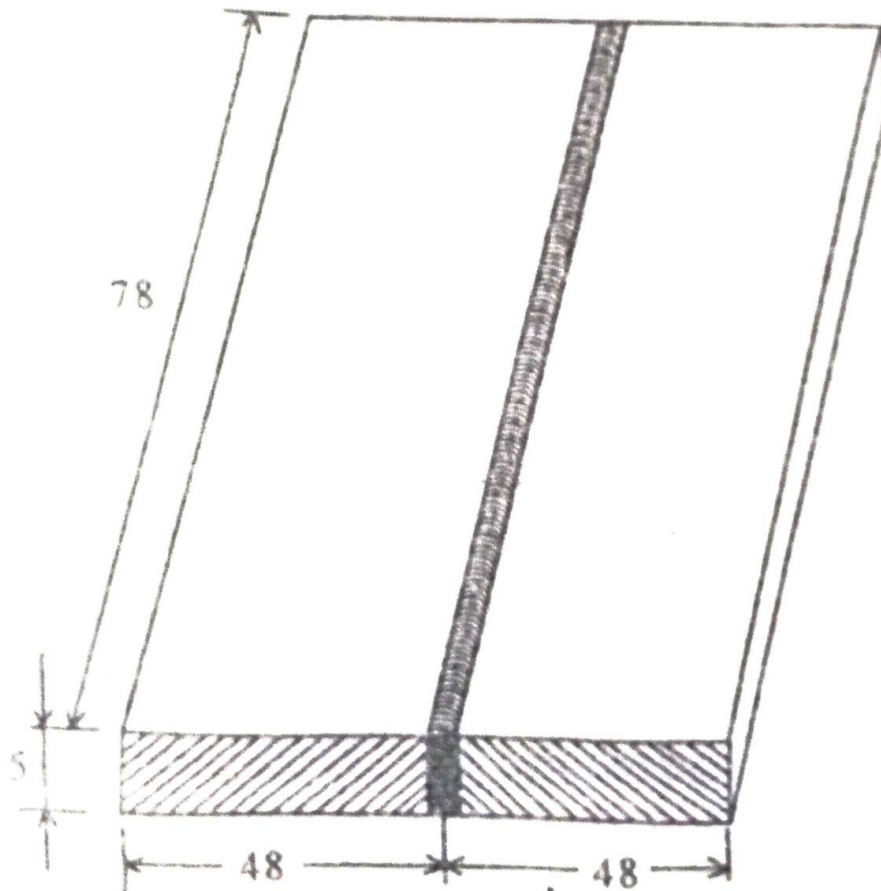

(Turn Over)

(2)

2. Prepare the job as shown below from M. S. Rod (ϕ 25).

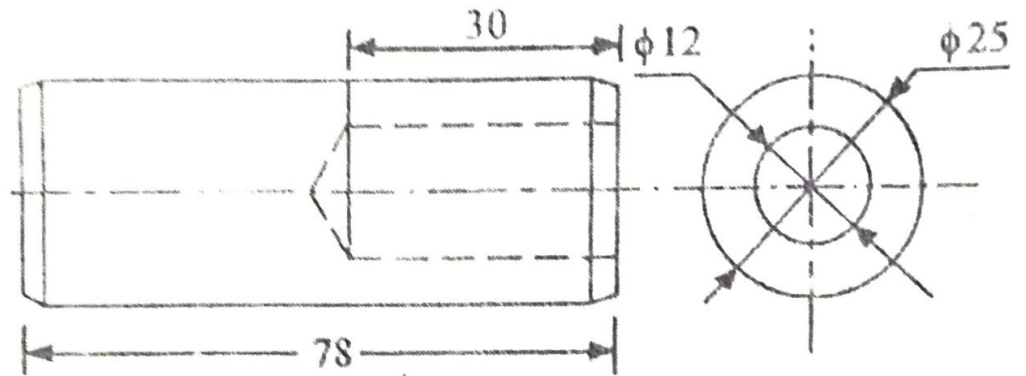

IV – Sem/MECHANICAL/2019(S)(New/Old)

WORKSHOP PRACTICE - III

(Code : MEP-402)

Full Marks : 50

Time : 4 hours

Prepare any one job

Figures in the right-hand margin indicate marks

1. Prepare the turning job using lathe as per the drawing shown in Fig.1. 50

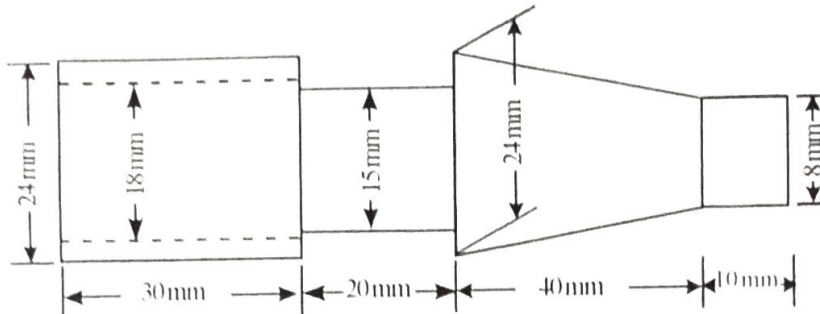

Fig. 1

2. Prepare the welding job using arc welding as per the drawing shown in Fig.2. 50

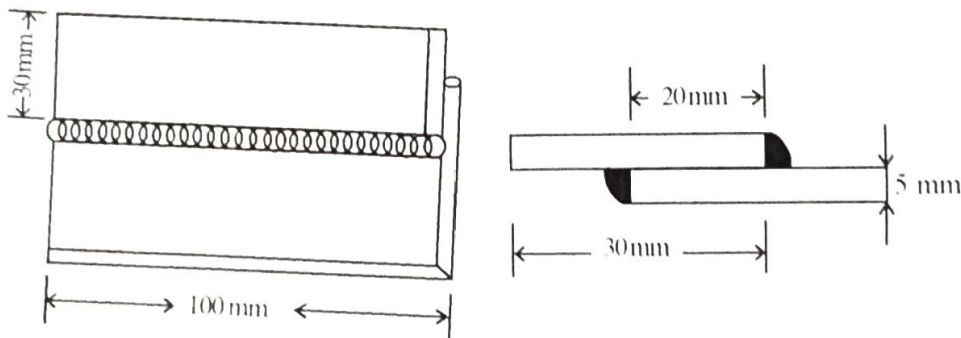

Fig. 2

IV - SEM /MECHANICAL/2022 (SUMMER)

WORKSHOP III

(Pr – 3)

Full mark : 50

Time : 4 hours

Prepare any one job including Q 1

(All the dimensions are in mm)

Q.1 What are the safety precautions needed during machine operation.

(10 MARKS)

(1 × 40 = 40 MARKS)

Q.2 Prepare the job using **SHAPER MACHINE** as per the diagram shown below.

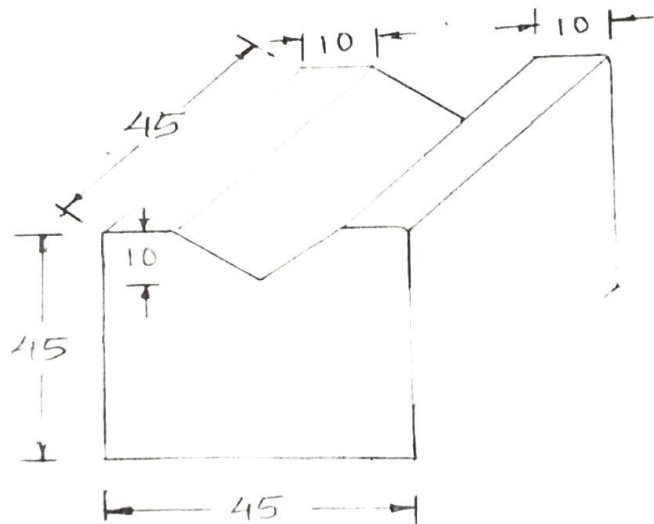

Q. 3 Prepare the threading job using **LATHE MACHINE** as per the figure given below.

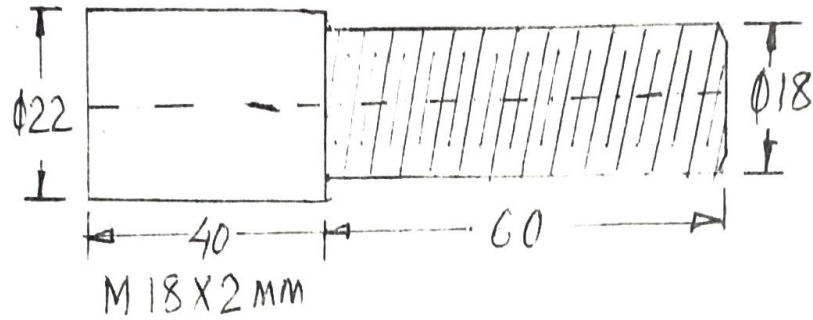

Q. 4 Prepare the job using **CAPSTAN AND RURRET LATHE** as per the figure given below.

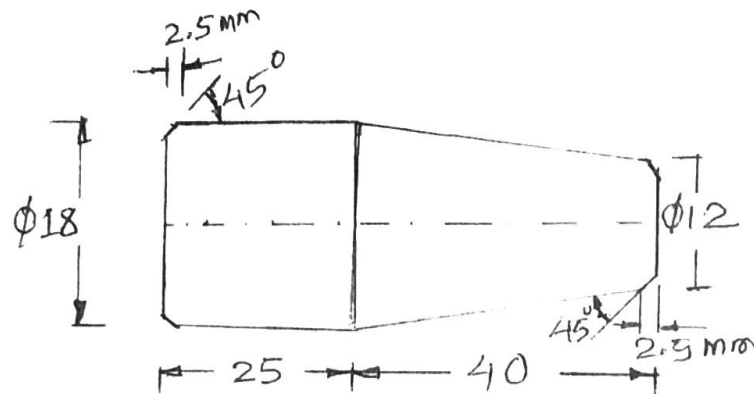

Page 2

END